

# PŁYTKI PROWADZĄCE SAMOSMARUJĄCE

## SELF-LUBRICATING WEAR PLATES

# PG04

### Material / Material

**BRAZ + GRAFIT**  
BRONZE + GRAPHITE  
HB > 190

### Jak zamówić / How to order

**Symbol:** PG04.075100

Inne wymiary na żądanie  
Other dimensions on demand

Śruby VS10 str. 447  
Screws VS10 page 447

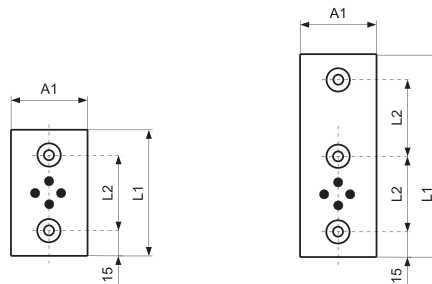

**FORMA A**  
FORM A

**FORMA B**  
FORM B

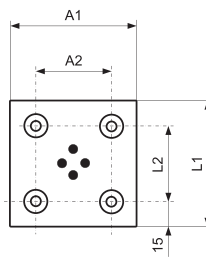

**FORMA C**  
FORM C

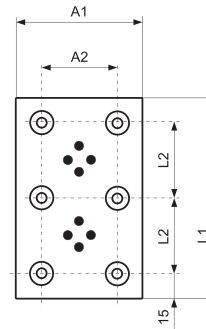

**FORMA D**  
FORM D

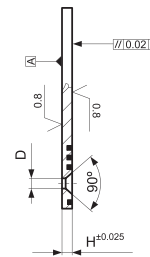

Symbol	A1	H	A2	L1	L2	D	FORMA FORM
PG04.018050	18	5	-	50	20	6,5	A
PG04.018075		5	-	75	45	6,5	A
PG04.018100		5	-	100	70	6,5	A
PG04.018150		5	-	150	60	6,5	B
PG04.028050	28	5	-	50	20	9	A
PG04.028075		5	-	75	45	9	A
PG04.028100		5	-	100	70	9	A
PG04.028150		5	-	150	60	9	B
PG04.028180	38	5	-	180	75	9	B
PG04.038050		5	-	50	20	9	A
PG04.038075		5	-	75	45	9	A
PG04.038100		5	-	100	70	9	A
PG04.038150	48	5	-	150	60	9	B
PG04.048075		5	-	75	45	9	A
PG04.048100		5	-	100	70	9	A
PG04.048125		5	-	125	95	9	A
PG04.048150	75	5	-	150	60	9	B
PG04.075075		5	45	75	45	9	C
PG04.075100		5	45	100	70	9	C
PG04.075125		5	45	125	95	9	C
PG04.075150	100	5	45	150	60	9	D
PG04.100100		5	70	100	70	9	C
PG04.100125		5	70	125	95	9	C
PG04.100150		5	70	150	60	9	D

Elementy prowadzące do tłoczników