

# NAKRĘTKI KRÓTKIE

TURNED SHORT NUTS

# S330

Materiał / Material

Automatyczny stop stalowy  
Automatic alloy steel

Jak zamówić / How to order

Symbol: S330.30030

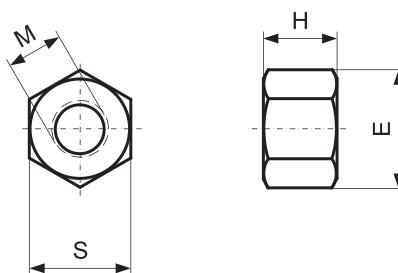

Symbol	M	S	E	H	WAGA / WEIGHT (G)
S330.08008	8	13	14,8	8	6
S330.10010	10	17	19,6	10	15
S330.12012	12	19	21,5	12	20
S330.14014	14	22	25	14	30
S330.16016	16	24	27,5	16	40
S330.18018	18	27	31	18	60
S330.20020	20	30	34,6	20	80
S330.22022	22	32	36,9	22	95
S330.24024	24	36	41,6	24	135
S330.27027	27	41	47,3	27	195
S330.30030	30	46	53,1	30	275
S330.36036	36	55	63,5	36	465
S330.42042	42	65	75	42	790
S330.48048	48	75	86,5	48	1200

# NAKRĘTKI WYSOKIE

TURNED TALL NUTS

## DIN 6330B

# S340

Materiał / Material

Automatyczny stop stalowy  
Automatic alloy steel

Jak zamówić / How to order

Symbol: S340.30045

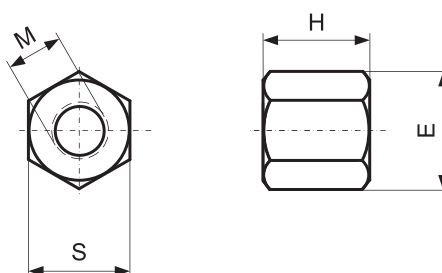

Symbol	M	S	E	H	WAGA / WEIGHT (G)
S340.06009	6	10	11,5	9	5
S340.08012	8	13	14,8	12	9
S340.10015	10	17	19,6	15	20
S340.12018	12	19	21,5	18	28
S340.14021	14	22	25	21	45
S340.16024	16	24	27,5	24	58
S340.18027	18	27	31	27	83
S340.20030	20	30	34,6	30	110
S340.22033	22	32	36,9	33	130
S340.24036	24	36	41,6	36	195
S340.27041	27	41	47,3	40	280
S340.30045	30	46	53,1	45	405
S340.36054	36	55	63,5	54	715
S340.42063	42	65	75	63	1170
S340.48072	48	75	86,5	72	1800