

# WYPYCHACZE AZOTOWANE Z ŁBEM CYLINDRYCZNYM

# ECO

EJECTOR PINS NITRIDED WITH CYLINDRICAL HEAD

## DIN 1530 / ISO 6751

### Materiał / Material

**WS - 1.2344**  
**Łeb spęczany. Trzpień szlifowany i azotowany gazowo**  
*Cylindrical head hot folded. Shaft fine ground finished and plasma nitrided*

### Twardość / Hardness

**Powierzchnia / Surface** **70 HRC**  
**Łeb / Head** **45±5 HRC**

### Warunki pracy / working conditions

**Odporność temp./ Temp. resistance:** 650 °C  
**Wytrzymałość rdzenia / Core STRENGTH approx.** 150Kp/mm<sup>2</sup>

### Jak zamówić / How to order

**Symbol:** ECO  
**d1:** + 10,0  
**L:** + 500

ECO.1000.0500

**Inne wymiary na żądanie**  
*Other dimensions on demand*

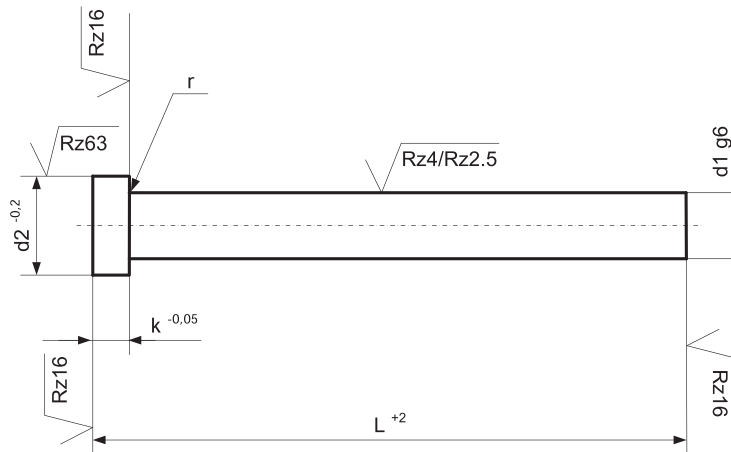

d1	d2	k	r	L +2												
				100	125	160	200	250	315	400	500	630	800	1000		
1.0	2.5	1.2	0.2	x	x	x	x									
1.1	2.5	1.2	0.2	x	x	x	x									
1.2	2.5	1.2	0.2	x	x	x	x									
1.3	3.0	1.5	0.2	x	x	x	x									
1.4	3.0	1.5	0.2	x	x	x	x									
1.5	3.0	1.5	0.2	x	x	x	x									
1.6	3.0	1.5	0.2	x	x	x	x									
1.7	3.0	1.5	0.2	x	x	x	x									
1.8	3.0	1.5	0.2	x	x	x	x									
1.9	3.0	1.5	0.2	x	x	x	x									
2.0	4.0	2.0	0.2	x	x	x	x	x	x	x						
2.1	4.0	2.0	0.2	x	x	x	x	x	x							
2.2	4.0	2.0	0.2	x	x	x	x	x	x							
2.5	5.0	2.0	0.3	x	x	x	x	x	x							
2.6	5.0	2.0	0.3	x	x	x	x	x	x							
2.7	5.0	2.0	0.3	x	x	x	x	x	x							
3.0	6.0	3.0	0.3	x	x	x	x	x	x	x	x					
3.1	6.0	3.0	0.3	x	x	x	x	x	x	x						
3.2	6.0	3.0	0.3	x	x	x	x	x	x	x						
3.5	7.0	3.0	0.3	x	x	x	x	x	x	x	x					
3.6	7.0	3.0	0.3	x	x	x	x	x	x	x						
3.7	7.0	3.0	0.3	x	x	x	x	x	x							
4.0	8.0	3.0	0.3	x	x	x	x	x	x	x	x	x				
4.1	8.0	3.0	0.3	x	x	x	x	x	x	x						
4.2	8.0	3.0	0.3	x	x	x	x	x	x	x	x					
4.5	8.0	3.0	0.3	x	x	x	x	x	x	x	x					
4.6	8.0	3.0	0.3	x	x	x	x									
5.0	10.0	3.0	0.3	x	x	x	x	x	x	x	x	x	x			
5.1	10.0	3.0	0.3	x	x	x	x	x	x	x						
5.2	10.0	3.0	0.3	x	x	x	x	x	x	x	x					
5.5	10.0	3.0	0.3	x	x	x	x	x	x	x	x	x				
6.0	12.0	5.0	0.5	x	x	x	x	x	x	x	x	x	x			
6.1	12.0	5.0	0.5	x	x	x	x									
6.2	12.0	5.0	0.5	x	x	x	x	x	x	x	x					
6.5	12.0	5.0	0.5	x	x	x	x	x	x	x	x					
7.0	12.0	5.0	0.5	x	x	x	x	x	x	x	x					
7.5	12.0	5.0	0.5	x	x	x	x	x	x	x						
8.0	14.0	5.0	0.5	x	x	x	x	x	x	x	x	x				
8.2	14.0	5.0	0.5	x	x	x	x	x	x	x	x					
8.5	14.0	5.0	0.5	x	x	x	x	x	x	x	x					
9.0	14.0	5.0	0.5	x	x	x	x	x	x	x	x					
10.0	16.0	5.0	0.5	x	x	x	x	x	x	x	x	x				
10.2	16.0	5.0	0.5	x	x	x	x	x	x	x	x					
10.5	16.0	5.0	0.5	x	x	x	x	x	x	x	x					
11.0	16.0	5.0	0.5	x	x	x	x	x	x	x	x					
12.0	18.0	7.0	0.8	x	x	x	x	x	x	x	x	x	x			
12.2	18.0	7.0	0.8	x	x	x	x	x	x	x	x					
12.5	18.0	7.0	0.8	x	x	x	x	x	x	x	x					
14.0	22.0	7.0	0.8	x	x	x	x	x	x	x	x	x	x			
16.0	22.0	7.0	0.8	x	x	x	x	x	x	x	x	x	x			
18.0	24.0	7.0	0.8	x	x	x	x	x	x	x	x	x	x			
20.0	26.0	8.0	1.1	x	x	x	x	x	x	x	x	x	x	x		
25.0	32.0	10.0	1.1					x	x	x	x	x	x	x	x	
32.0	40.0	10.0	1.1						x	x	x	x	x	x	x	

Wypychacze do form wtryskowych