

# PŁYTKI PROWADZĄCE STALOWE

## STEEL WEAR PLATES

### VDI 3357

# PG13

Materiał / Material

16 MnCr5

Twardość / Hardness

58 + 60 HRC

Jak zamówić / How to order

Symbol: **PG13.125080**

Sruby V8 / V12 str. J144  
Screws V8 / V12 page J144

Inne wymiary na życzenie  
Other dimensions on demand

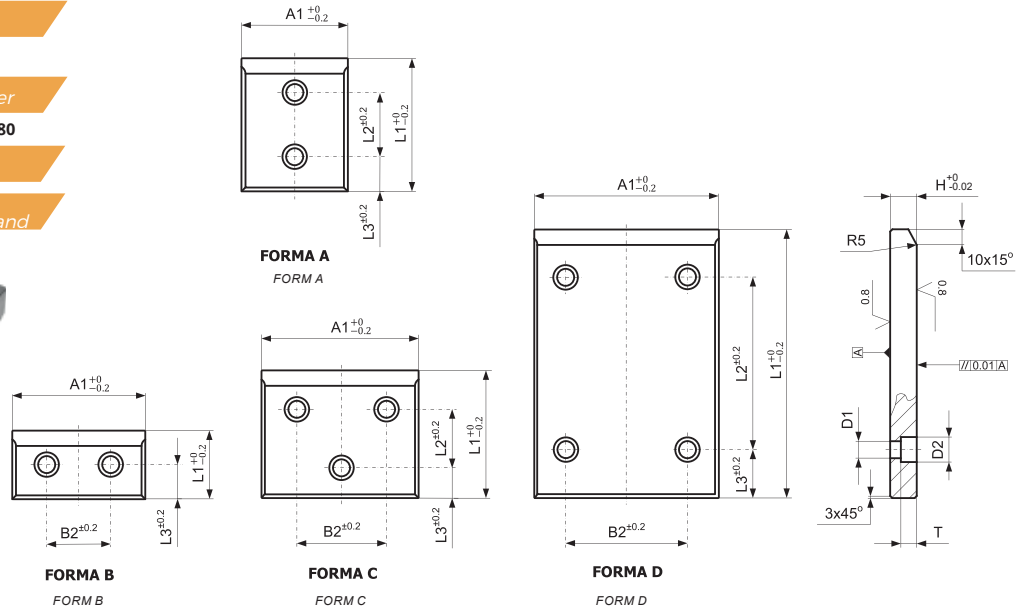

Symbol	A1	H	L1	B2	L2	L3	D1	D2	T	FORMA FORM
PG13.050080	50	20	80	-	30	25	9	15	9	A
PG13.050100		20	100	-	50	25	13,5	20	13	A
PG13.050125		20	125	-	75	25	13,5	20	13	A
PG13.050160		20	160	-	110	25	13,5	20	13	A
PG13.050200		20	200	-	150	25	13,5	20	13	A
PG13.080050	80	20	50	30	-	25	9	15	9	B
PG13.080080		20	80	-	30	25	13,5	20	13	A
PG13.080100		20	100	-	50	25	13,5	20	13	A
PG13.080125		20	125	-	75	25	13,5	20	13	A
PG13.080160		20	160	-	110	25	13,5	20	13	A
PG13.080200		20	200	-	150	25	13,5	20	13	A
PG13.080250		20	250	-	170	40	13,5	20	13	A
PG13.100050	100	20	50	50	-	25	13,5	20	13	B
PG13.100080		20	80	50	-	40	13,5	20	13	B
PG13.100100		20	100	-	50	25	13,5	20	13	A
PG13.100125		20	125	-	75	25	13,5	20	13	A
PG13.100160		20	160	-	110	25	13,5	20	13	A
PG13.100200		20	200	-	150	25	13,5	20	13	A
PG13.100250		20	250	-	170	40	13,5	20	13	A
PG13.100315		20	315	-	235	40	13,5	20	13	A
PG13.125050	125	20	50	75	-	25	13,5	20	13	B
PG13.125080		20	80	75	-	40	13,5	20	13	B
PG13.125100		20	100	75	50	25	13,5	20	13	C
PG13.125125		20	125	75	75	25	13,5	20	13	C
PG13.125160		20	160	75	110	25	13,5	20	13	C
PG13.125200		20	200	75	150	25	13,5	20	13	C
PG13.125250		20	250	75	170	40	13,5	20	13	C
PG13.125315		20	315	75	235	40	13,5	20	13	C
PG13.160050	160	20	50	110	-	25	13,5	20	13	B
PG13.160080		20	80	110	-	40	13,5	20	13	B
PG13.160100		20	100	110	50	25	13,5	20	13	C
PG13.160125		20	125	110	75	25	13,5	20	13	C
PG13.160160		20	160	110	110	25	13,5	20	13	C
PG13.160200		20	200	110	150	25	13,5	20	13	C
PG13.160250		20	250	110	170	40	13,5	20	13	D
PG13.160315		20	315	110	235	40	13,5	20	13	D