

PŁYTKI PROWADZĄCE STALOWE

STEEL WEAR PLATES

PG30

Materiał / Material

CK45

Twardość / Hardness

58 ± 60 HRC

Jak zamówić / How to order

Symbol: PG30.12530250

Śruby V8 / V12 str. J144
Screws V8 / V12 page J144

Inne wymiary na życzenie
Other dimensions on demand

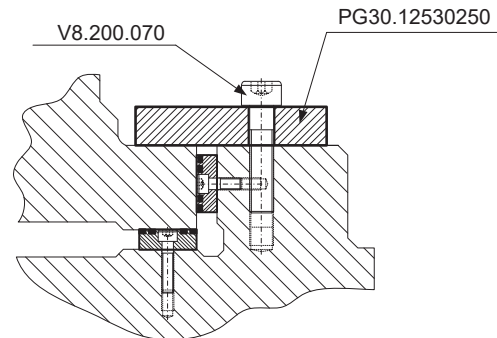
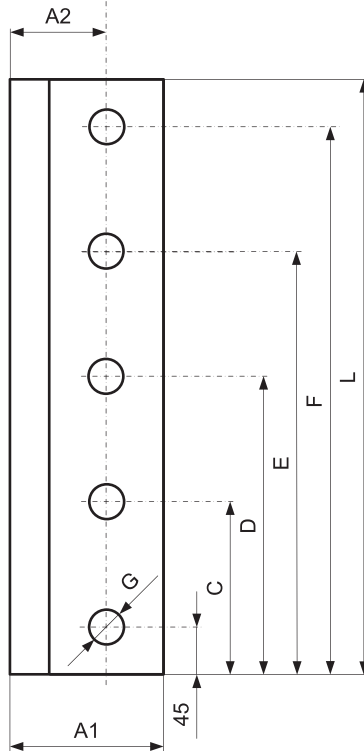
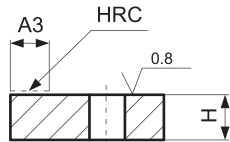

PRZYKŁAD ZASTOSOWANIA
APPLICATION EXAMPLE

Symbol	A1	A2	A3	L	H	C	D	E	F	G	ŚRUBY SCREWS
PG30.07525160	75	40	25	160	25	-	-	-	115	17	2x M16x60
PG30.07525200		40	25	200	25	-	-	-	155	17	2x M16x60
PG30.07525250		40	25	250	25	-	125	-	205	17	3x M16x60
PG30.10025160	100	60	30	160	25	-	-	-	115	17	2x M16x60
PG30.10025200		60	30	200	25	-	-	-	155	17	2x M16x60
PG30.10025250		60	30	250	25	-	125	-	205	17	3x M16x60
PG30.10025400	60	30	400	25	125	200	275	355	17	5x M16x60	
PG30.10030160	100	60	30	160	30	-	-	-	115	21	2x M20x70
PG30.10030200		60	30	200	30	-	-	-	155	21	2x M20x70
PG30.10030250		60	30	250	30	-	125	-	205	21	3x M20x70
PG30.10030400		60	30	400	30	125	200	275	355	21	5x M20x70
PG30.12530160	125	75	30	160	30	-	-	-	115	21	2x M20x70
PG30.12530200		75	30	200	30	-	-	-	155	21	2x M20x70
PG30.12530250		75	30	250	30	-	125	-	205	21	3x M20x70
PG30.12530400		75	30	400	30	125	200	275	355	21	5x M20x70