

PŁYTKI PROWADZĄCE Z WKŁADKAMI BRAZOWYMI SAMOSMARUJĄCYMI

WEAR PLATES WITH SELF-LUBRICATING BRONZE PLATE

PG42

Materiał / Material

WKŁADKA: BRĄZ + GRAFIT HB > 190
STAL: 16MnCr5
INSERTION: BRONZE + GRAPHITE HB > 190
STEEL: 16MnCr5

Jak zamówić / How to order

Symbol: **PG42.125250**

Śruby V8 / V12 str. J144
Screws V8 / V12 page J144

Inne wymiary na żądanie
Other dimensions on demand

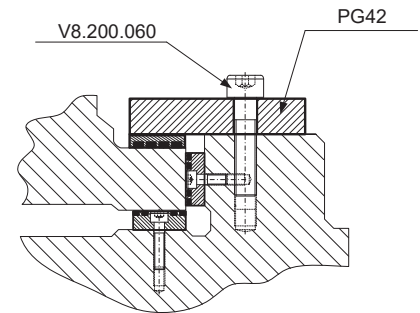
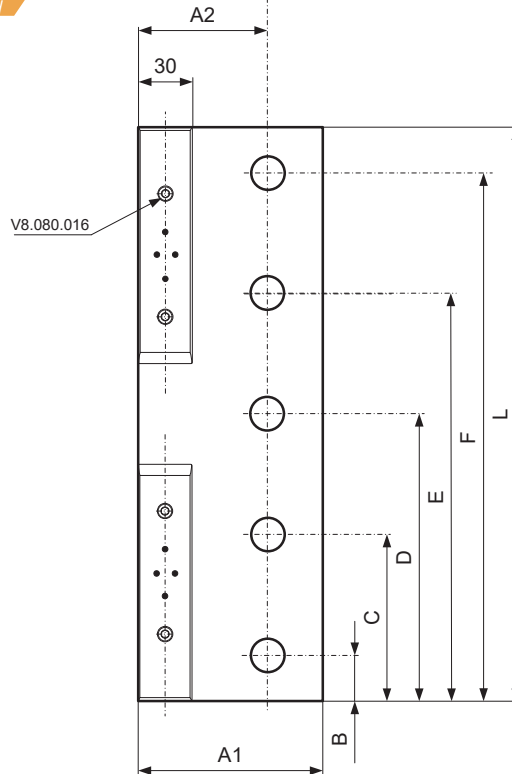
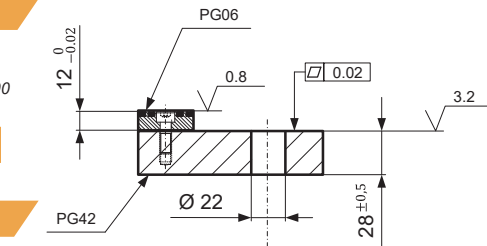

PRZYKŁAD ZASTOSOWANIA
APPLICATION EXAMPLE

Symbol	A1	A2	L	B	C	D	E	F	ŚRUBY SCREWS
PG42.085160	85	60	160	45	115	-	-	-	2x M20x60
PG42.085200		60	200	45	155	-	-	-	2x M20x60
PG42.085250		60	250	45	125	205	-	-	3x M20x60
PG42.085300		60	300	45	150	255	-	-	3x M20x60
PG42.085350		60	350	45	175	305	-	-	3x M20x60
PG42.085400		60	400	45	125	200	275	355	5x M20x60
PG42.085450		60	450	50	130	225	320	400	5x M20x60
PG42.085500		60	500	50	130	250	370	450	5x M20x60
PG42.125160	125	75	160	45	115	-	-	-	2x M20x60
PG42.125200		75	200	45	155	-	-	-	2x M20x60
PG42.125250		75	250	45	125	205	-	-	3x M20x60
PG42.125300		75	300	45	150	255	-	-	3x M20x60
PG42.125350		75	350	45	175	305	-	-	3x M20x60
PG42.125400		75	400	45	125	200	275	355	5x M20x60
PG42.125450		75	450	50	130	225	320	400	5x M20x60
PG42.125500		75	500	50	130	250	370	450	5x M20x60